

35% carbamide peroxide
advanced tooth whitening system

INSTRUCTIONS FOR USE

Pola Day CP is a 35% carbamide peroxide, high viscosity, neutral pH tooth whitening gel. It is a pleasantly flavoured, crystal clear sustained release gel with a water content high enough to reduce sensitivity.

INDICATIONS FOR USE:

- Whitening of discoloured vital teeth.
- Whitening of discoloured non-vital teeth.

COMPOSITION: 35% Carbamide peroxide
40% Water
0.5% Flavour
24.5% Thickening agents

NET WEIGHT:

Depending on kit purchased, 1.3g syringes or 3g syringes. Please refer to outside of box.

HYDROGEN PEROXIDE EQUIVALENT:

Pola Day CP 35% Carbamide Peroxide = 11.7% Hydrogen Peroxide

PLACEMENT PROCEDURE:

1. Place a small drop of gel into every compartment of the tray for the teeth undergoing treatment.
2. Seat the tray, with the gel around the teeth.
3. Wipe away excess gel in mouth with a tissue or dry soft brush.
4. After 15 minutes of treatment, remove tray. Rinse tray and mouth with lukewarm water.
Note: Treatment time can be up to 30 minutes if required.
5. Brush teeth.

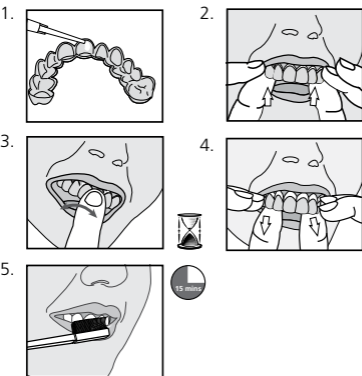
**IN-OFFICE JUMP START (FOR DENTAL PROFESSIONALS)**

When used as a jump start in the dental office, treatment time is 30 minutes.

STORAGE AND HANDLING:

- Store product in the refrigerator (2°-8°C / 35°-45°F).
- Do not use after expiration date.
- Use product at room temperature.

PRECAUTIONS:

- Irritant. Attacks eyes – protect eyes when using. Avoid swallowing.
- To be used under the supervision of a dental professional.
- Do not eat, drink or smoke during treatment.
- Do not smoke immediately after treatment - wait for at least two hours.
- Food and drinks containing strong colours should be avoided or consumed in moderation during the entire treatment period.
- Keep out of reach of children and pets.
- Not to be used by pregnant or lactating women or children under 14 years old.
- Patients with a history of chemical allergies are advised to carry out allergy testing by a specialist before using this product.
- Discontinue use if any unusual sensitivity or reactions occur and consult your dentist.
- Do not inject Pola Day CP into the body.
- MSDS available at www.sdi.com.au or contact your regional representative.

FIRST AID:

For advice, contact a Poisons Information Centre (Australia 131 126, New Zealand 0800 764 766) or a doctor. If swallowed, do not induce vomiting. If in eyes, hold eyelids apart and flush the eye continuously with running water. Continue flushing until advised to stop by the Poisons Information Centre or a doctor, or for at least 15 minutes. If skin or hair contact occurs, remove contaminated clothing and flush skin and hair with running water. Seek medical advice if symptoms persist.

Made in Australia by SDI Limited
Bayswater, Victoria 3153
Australia 1 800 337 003
Austria 00800 022 55 734
Brazil 0800 770 1735
France 00800 022 55 734
Germany 0800 100 5759
Ireland 01 886 9577
Italy 800 780625
New Zealand 0800 734 034
Spain 00800 022 55 734
United Kingdom 00800 022 55 734
USA & Canada 1 800 228 5166
www.sdi.com.au
www.polawhite.com.au

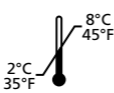

Warning

Causes
skin & eye
irritation